

Application to Henbury, Brentry and Southmead Neighbourhood Partnership for the release of S106 monies: Brentry Hospital, Brenty Lane, Brentry, Planning application

12/01932

In association with the above planning approval Section 106 monies have been allocated to be spent on “the cost of improving facilities for pedestrians and cyclists on public right of way BCC/542 including surface treatment and lighting”.

The plan below shows the extent of the public footpath which is 430 metres long. BCC/542 is highlighted in red.

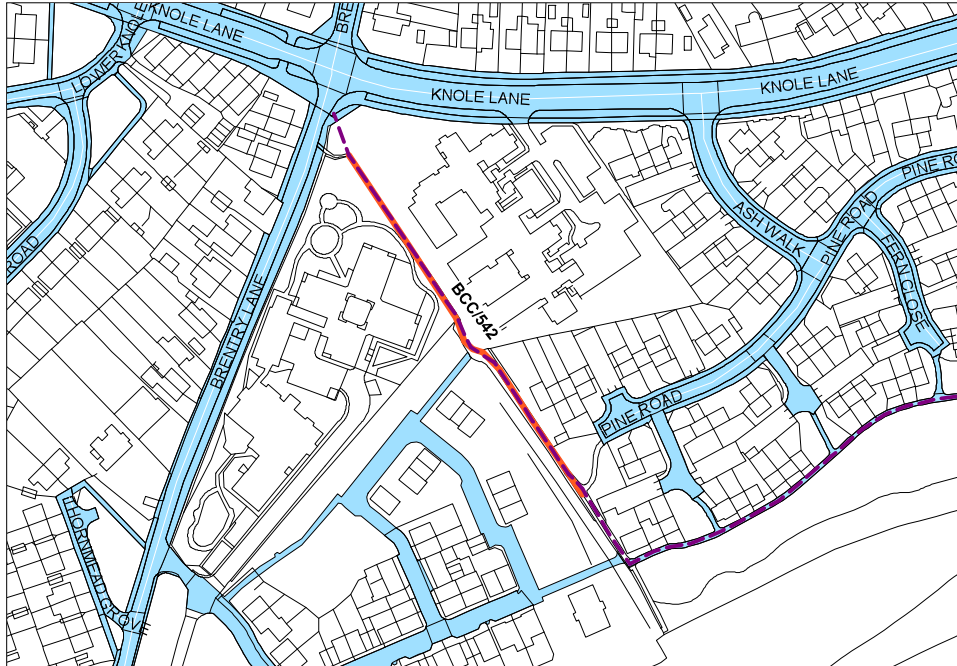

The amount held is currently £42,618.45. The release of monies will enable the proposed improvement to be designed and implemented within the period set out in the S106 agreement which is 17 November 2020.

The first steps will be to write the design brief for engineering practise, undertake the initial collection of information and commission a topographical survey. This should be completed within 4 months from the release of the monies.

Following this survey, the improvements will be designed to maximise access for all on this constrained site observing equalities guidance. The improvements have to be designed within the current path boundaries, if opportunities arose to widen the public footpath they would be investigated. The new tarmac surface will be an improvement on the current situation and nothing designed as part of this scheme will adversely affect the accessibility to the current path users. It is hoped that with the improvements more users may use the route.

The connection onto Brentry Lane is planned to be improved as part of the approved planning application 14/02757/F Humphry Repton House, Brentry. The design is included in that planning application and will be delivered separately to this scheme. This covers the first 13 metres from the road to the Humphrey Repton site boundary and is shown uncoloured on the plan above.

Consultation procedures for schemes via the neighbourhood partnership are currently uncertain. When this has been established, progress on the scheme and its design will be reported back to that group.

It is anticipated that by starting the process now the improvement will be completed within the timescale.

Mary Knight, Public Rights of Way Officer

Pine Road to Brentry Lane

Looking towards Pine Road



Looking towards Brentry Lane

